

PERKINS —  
EASTMAN

*Human by Design*

CHARLOTTE-MECKLENBURG SCHOOLS  
Lansdowne Elementary

# PROJECT UPDATE



# SITE PLAN

## LANSLOWNE ELEMENTARY



# SITE PLAN DROP-OFF

## LANSLOWNE ELEMENTARY



# PLAN - LOWER LEVEL

## LANSDOWNNE ELEMENTARY

- DEPARTMENT
- 01 - GENERAL CLASSROOMS
  - 02 - SUPPORT SPACES
  - 03 - ELECTIVE CLASSROOMS
  - 04 - MEDIA CENTER
  - 05 - PHYSICAL EDUCATION
  - 06 - ADMINISTRATION
  - 07 - CAFETERIA
  - 08 - BUILDING SUPPORT
  - 09 - NON ASSIGNABLE



# PLAN - UPPER LEVEL

## LANSLOWNE ELEMENTARY

- DEPARTMENT
- 01 - GENERAL CLASSROOMS
  - 02 - SUPPORT SPACES
  - 05 - PHYSICAL EDUCATION
  - 08 - BUILDING SUPPORT
  - 09 - NON ASSIGNABLE





# ELEVATIONS

# ELEVATIONS

## LANSDOWNNE ELEMENTARY



# ELEVATIONS

## LANSDOWNNE ELEMENTARY





# ELEVATIONS

## LANSDOWNNE ELEMENTARY



---

# ELEVATIONS

## LANSDOWNE ELEMENTARY



---

# ELEVATIONS

## LANSDOWNNE ELEMENTARY



---

# ELEVATIONS

## LANSDOWNNE ELEMENTARY



---

# ELEVATIONS

## LANSDOWNNE ELEMENTARY





# PHASING

# PHASING

## PHASE 1

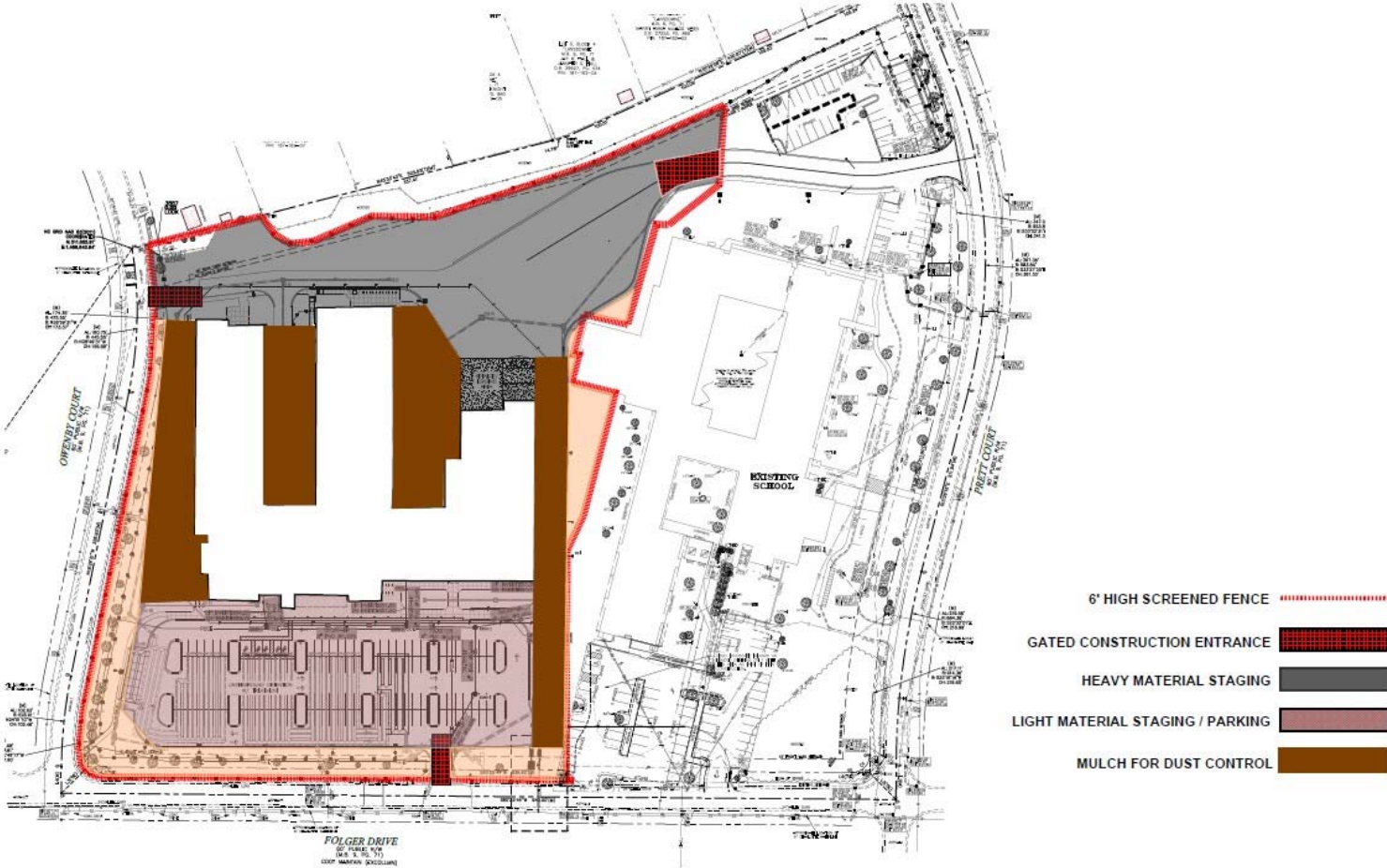

# PHASING

## PHASE 2





# PHASING

FINAL





**SCHEDULE**

# PROJECT SCHEDULE

-  Spring Semester
-  Fall Semester
-  CD Complete
-  Notice To Proceed
-  Teacher Move-in
-  Project Completion

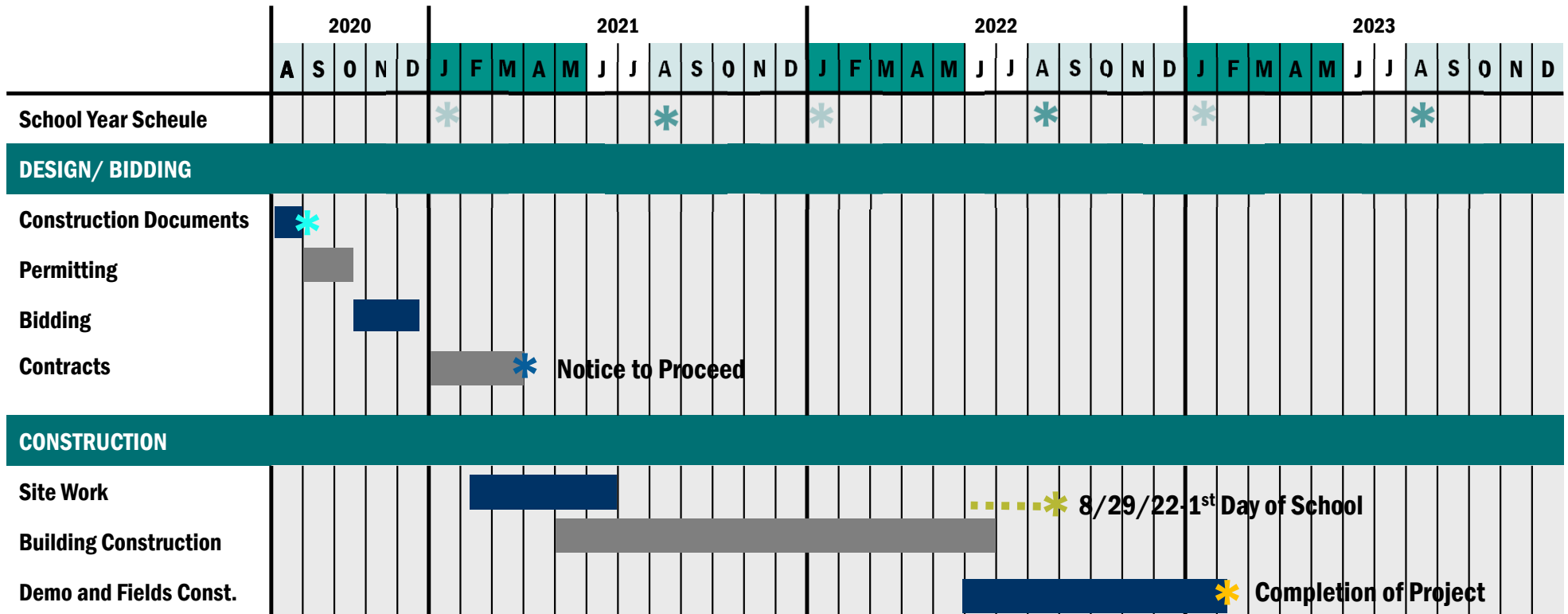



**QUESTIONS**